

## CARACTERÍSTICAS

**MATERIAL** hormigón armado  
**COLOR** gris / terracota / verde / beige  
**ACABADO** decapado e hidrofugado  
**COLOCACIÓN** simplemente apoyado (macizo)  
 anclado con tornillos (flotante)  
**PESO** 1700 kg / 840 kg  
**PALET** 80x300/110x310 (macizo)  
 sin palet (flotante)

**MATERIAL** reinforced cast stone  
**COLOUR** grey / terracota / green / beige  
**FINISH** acid-etched and waterproofed  
**FIXING** free-standing (macizo)  
 anchored with screws (flotante)  
**WEIGHT** 1700 kg / 840 kg  
**PALLET** 80x300/110x310  
 without pallet (flotante)

DISEÑO / DESIGN Jose Antonio Martínez Lapeña / Elias Torres

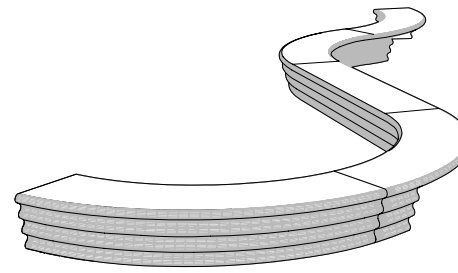

ESCALA 0 CM 50 CM

## SISTEMA DE COLOCACION

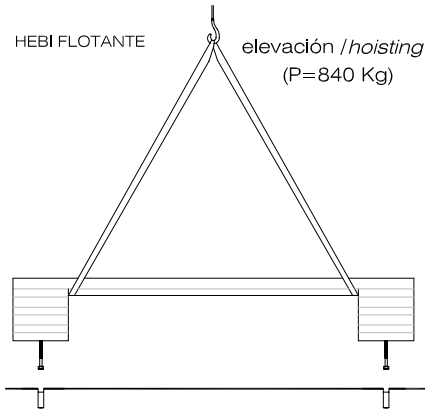

rosca los 2 tornillos a fondo M-16x140  
tightly screw the 2 stud bolts M-16x140

taladrar el pavimento y llenar con resina o mortero rico.  
drill pavement and fill with resin or fat mortar

centrar, colocar el banco y rejuntar la zona de apoyo  
centre and caulk the bench foot all around

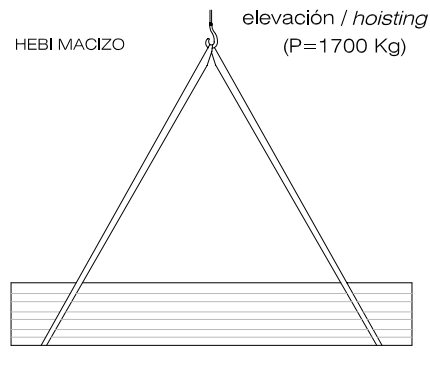

ELEMENTOS SIMPLEMENTE APOYADOS  
SIMPLY SUPPORTED ELEMENT

## GEOMETRIA

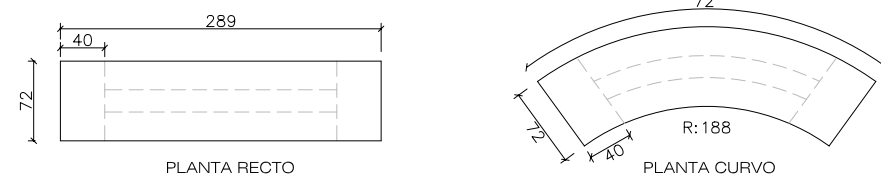
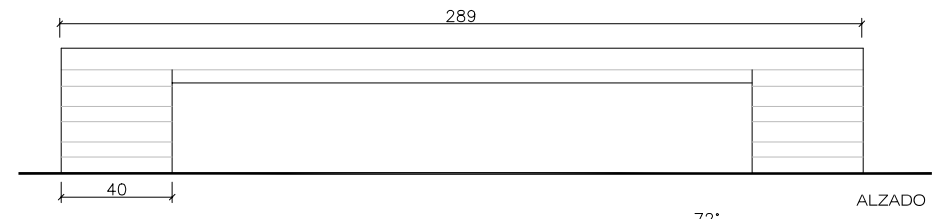
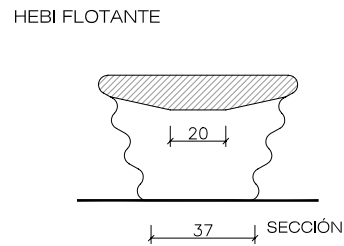
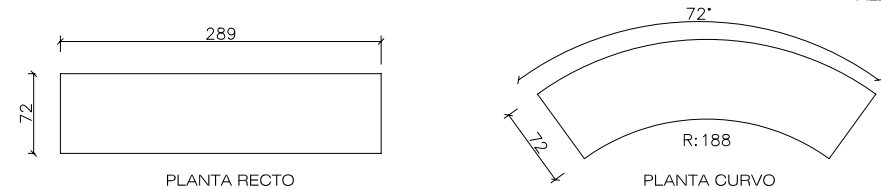
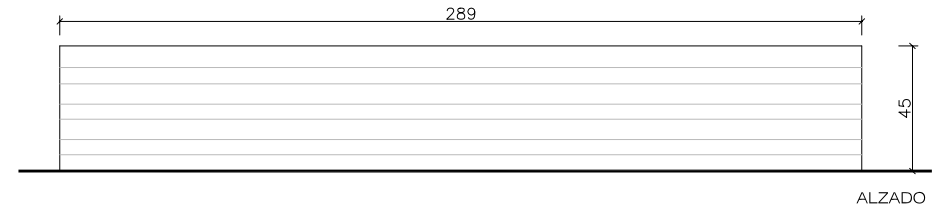
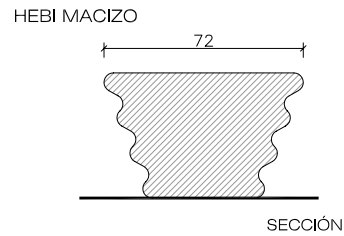

## EJEMPLO DE AGREGACION

